

Owner

Somers. Carrie E.

No.

68

Sec.

C.C.

Area
12'x12' =
144 sq. ft.

Representative

(May 27, 1921.)

Price of Lot

\$57.60

Dept for Per. Care

1420

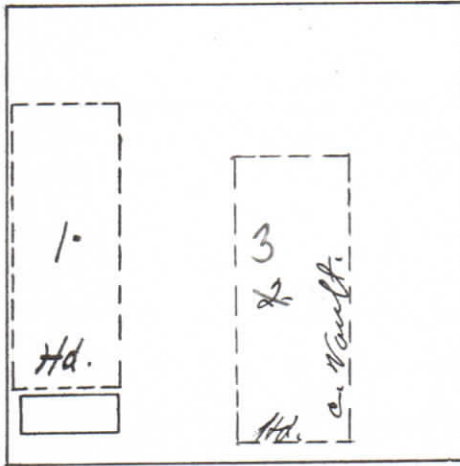

West
1 in. = 5 ft.

NAME	GRAVE NO.
Walter T. Drew. Bur. June 5, 1921.	1
Emery Drew " Oct. 7, 1953	3
	3
	4
	5
	6
	7
	8

INTERMENT

Name **Drew, Emery**

Interment No. **8737** No. **68** Lot **CC** Sec.

Date of Burial **Oct. 7, 1953** Died **Oct. 4, 1953**

Age **80** Yrs. **9** Mo. Days

Undertaker **Walter Curffe, 15 Johnson St., Lynn, Mass.**

Remarks: **C. Linner - 2nd from south on west - Gr. #2**

1420

INTERMENT

Name **Drew, Walter T.**

Interment No. **1409** No. **68** Lot **PLK** Sec. **C.C.**

Date of Burial **Died France March 8, 1919.**

Age **Buried - June 5 - 1921** Yrs. Mo. Days

Undertaker **John Waters**

Remarks: **Grave #1 - north west cor of lot son of Emery & Carrie E (Drew) Somers.**

1420